

SENSAIz PoE AI Sensor IMX500 12.3MP (P/N: SZP1235-001)

Step. 1

Pass cable through back case bracket

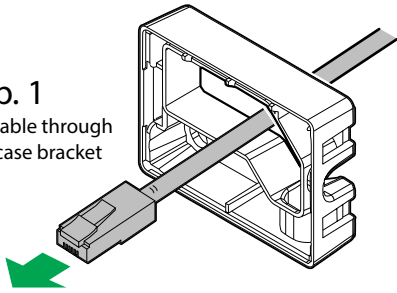

Important!

Use only "bootless" cable

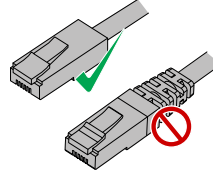

Make sure LEDs are at the bottom

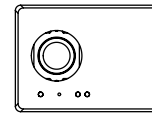

Top
↑
Proper Orientation
↓
Bottom

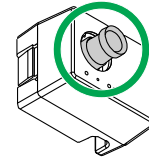

During installation and placement of the sensor, **do not hit or cause physical stress on the lens** as this might affect optical performance.

Step. 2

Adjust the cable orientation to fit into the one of the case's grooves or straight through, depending on your mounting surface.

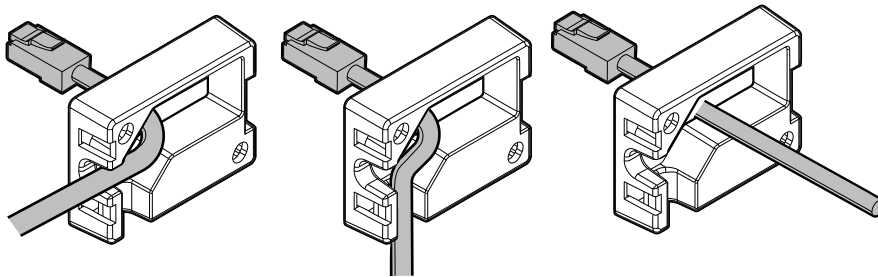

Step. 3

Mount back case bracket to surface using the screw holes.
Use #8 or similar screw, head size up to 8.5mm, mounting screws sold separately.

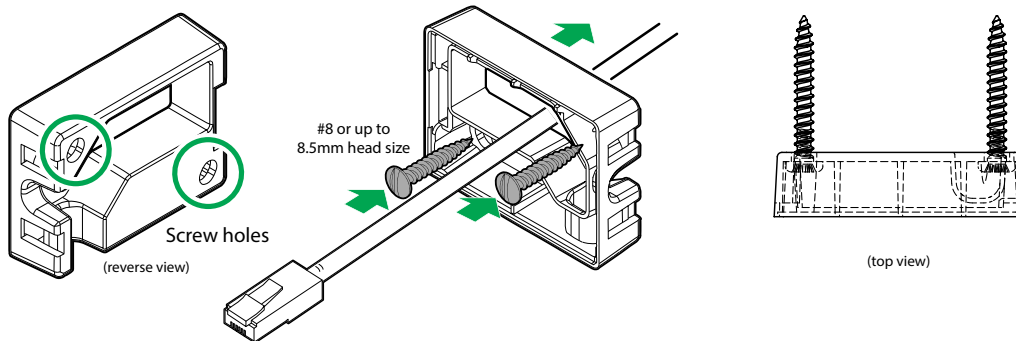

Step. 4

Connect the cable and sensor together.

